



# MMP-130S/3H



### Product code

[ ex : 30° hood / White / NORDIC type / Narrow 11° / 3000K ]

**MMP-130S/3H/W/1N/N/40B 30/N1/2**

Basic Product Series	Hood	Color	Track type	Light distribution	Light source	Color temperature	Driver type	Auth-entification
----------------------	------	-------	------------	--------------------	--------------	-------------------	-------------	-------------------

### ◎NORDIC type

Dimming | Non-dimming

White MMP-130S/3H/W/1N/N.M/40B27.30.35.40/N1/2

Matte black MMP-130S/3H/M/1N/N.M/40B27.30.35.40/N1/2

Silver MMP-130S/3H/S/1N/N.M/40B27.30.35.40/N1/2

### Products Specifications

• Input Voltage	AC120V
• Power consumption	53.9W(AC120V)
• Luminance flux	4,161 ~ 4,577 lm
• Color rendering	CRI (Ra)=93(typ)
• Fixture's weight	2.40 lbs
• Light distribution	Narrow (11°) Medium (18°)
• Input current	0.454A (120V)
• Aiming distance	0.3m (11 13/16 in)
• Tilting angle	100°
• Filter lighting®	2 Filters

### Size

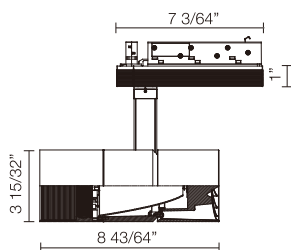

### Track system designation

NORDIC : type TEK-44,48,412  
NORDIC ALUMINIUM INC

• This fixture is compatible with 2-circuit track only.  
The fixture attaches to both the left and right circuit rails of the track.  
Please ensure that only one power feed is supplied to the track.

### Additional Accesaries

#### • Lens Filter

Full-Diffuser lens filter

MLA-130/DF01



[data download](#)

Semi-Diffuser lens filter

MLA-130/DS02



[data download](#)

Full-spread lens filter

MLA-130/SF01



[data download](#)

Semi-Spread lens filter

MLA-130/SS01



[data download](#)

Edge-control lens filter

MLA-130/EC02



[data download](#)

Sharpeners lens filter

MLA-130/SH01



[data download](#)

### Installation

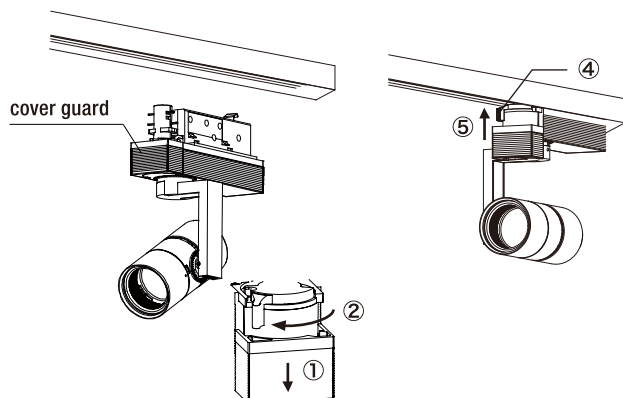

① Pull down the cover guard.  
② Rotate the gear lever.

③ Push the driver box against the lighting rail.  
④ Rotate the gear lever and lock it.  
⑤ Push up the cover guard.

### How to do tilt lock / pan lock

Each angle can be locked by allen wrench attached.

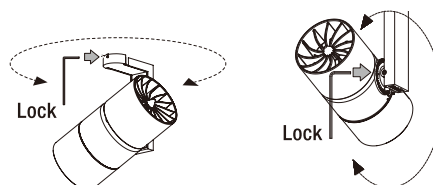

## Light distribution

### Narrow : 11°

N	11°				
H(ft)	E(ft-cd)	D(ft)	E(ft-cd)	2700K	3000K
3.28	3806	0.66	3.28ft	3607	3806
6.56	952	1.31	6.56ft	902	952
9.84	423	1.97	9.84ft	401	423
13.12	238	2.62	13.12ft	225	238
40967cd					

3000K / 4390Lm

### Medium : 18°

M	18°				
H(ft)	E(ft-cd)	D(ft)	E(ft-cd)	2700K	3000K
3.28	2446	1.08	3.28ft	2318	2446
6.56	611	2.17	6.56ft	580	611
9.84	272	3.25	9.84ft	258	272
13.12	153	4.33	13.12ft	145	153
26326cd					

3000K / 4390Lm

## Light distribution with Filter lighting®



### Full-Diffuser lens filter | MLA-130/DF01

N	42°				
H(ft)	E(ft-cd)	D(ft)	E(ft-cd)	2700K	3000K
3.28	227	2.56	3.28ft	227	256
6.56	57	5.12	6.56ft	25	7.68
9.84	25	7.68	9.84ft	14	10.24
13.12	14	10.24	13.12ft	14	10.24
2445cd					

for Narrow 3000K / 4390Lm



### Semi-Diffuser lens filter | MLA-130/DS02

M	32°				
H(ft)	E(ft-cd)	D(ft)	E(ft-cd)	2700K	3000K
3.28	505	1.84	3.28ft	505	1.84
6.56	126	3.67	6.56ft	56	5.51
9.84	56	5.51	9.84ft	31	7.35
13.12	31	7.35	13.12ft	31	7.35
5434cd					

for Narrow 3000K / 4390Lm



### Full-spread lens filter | MLA-130/SF01

N	13°/41°				
H(ft)	E(ft-cd)	D(ft)	E(ft-cd)	2700K	3000K
3.28	813	0.79/2.49	3.28ft	813	0.79/2.49
6.56	203	1.57/4.99	6.56ft	90	2.36/7.48
9.84	90	2.36/7.48	9.84ft	51	3.15/9.97
13.12	51	3.15/9.97	13.12ft	51	3.15/9.97
8753cd					

for Narrow 3000K / 4390Lm



### Semi-Spread lens filter | MLA-130/SS01

M	18°/33°				
H(ft)	E(ft-cd)	D(ft)	E(ft-cd)	2700K	3000K
3.28	1292	0.79/1.97	3.28ft	1292	0.79/1.97
6.56	323	1.57/3.94	6.56ft	144	2.36/5.91
9.84	144	2.36/5.91	9.84ft	81	3.15/7.87
13.12	81	3.15/7.87	13.12ft	81	3.15/7.87
13903cd					

for Narrow 3000K / 4390Lm



### Edge-control lens filter | MLA-130/EC02

N	32°				
H(ft)	E(ft-cd)	D(ft)	E(ft-cd)	2700K	3000K
3.28	3420	1.90	3.28ft	3420	1.90
6.56	855	3.81	6.56ft	380	5.71
9.84	380	5.71	9.84ft	213	7.61
13.12	213	7.61	13.12ft	213	7.61
3419cd					

for Narrow 3000K / 4390Lm



### Sharpening lens filter | MLA-130/SH01

N	9°				
H(ft)	E(ft-cd)	D(ft)	E(ft-cd)	2700K	3000K
3.28	3103	0.52	3.28ft	3103	0.52
6.56	776	1.05	6.56ft	345	1.57
9.84	345	1.57	9.84ft	194	2.10
13.12	194	2.10	13.12ft	194	2.10
33403cd					

for Narrow 3000K / 4390Lm

## The attachment of the filters



- Remove the lock by sliding the body along the arrow direction, and detach the hood from the body.



- Rotate the option holder in the hood along the arrow direction and take the option holder out from the hood.



- Put the filter into the hood.  
※ up to 2 filters can be inserted.  
※ The sharpening lens are counted as 2 lens.



- Put back the option holder to the hood.



- Match the mark of the hood and the body and rotate the hood to lock.

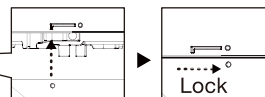

## Contact

**Mosheo Corporation**  
2B Airport Drive Ext. Hopedale, MA 01747  
Phone : +1-774-804-3283  
E-mail : ModuleXSales@Mosheocorp.com

# ModuleX