



MMP-100S/3H



Product code

[ex : 30° hood / White / NORDIC type / Narrow 11° / 3000K]

MMP-100S/3H/W/1N/N/30B 30/N1/2

Basic Product Series	Hood	Color	Track type	Light distribution	Light source	Color temperature	Driver type	Auth-entification
----------------------	------	-------	------------	--------------------	--------------	-------------------	-------------	-------------------

©NORDIC type

Dimming | Non-dimming

White MMP-100S/3H/W/1N/N.M/30B27.30.35.40/N1/2

Matte black MMP-100S/3H/M/1N/N.M/30B27.30.35.40/N1/2

Silver MMP-100S/3H/S/1N/N.M/30B27.30.35.40/N1/2

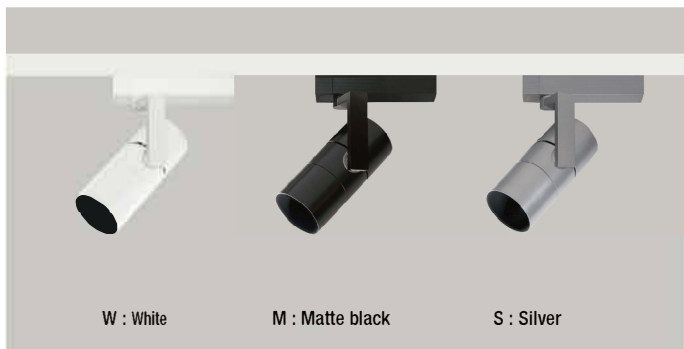

W : White

M : Matte black

S : Silver

Products Specifications

• Input Voltage	AC120V
• Power consumption	39.9W(AC120V)
• Luminance flux	2819 ~ 3106 lm
• Color rendering	CRI (Ra)=93(typ)
• Fixture's weight	1.84 lbs
• Light distribution	Narrow (11°) Medium (19°)
• Input current	0.334A (120V)
• Aiming distance	0.3m (11 13/16 in)
• Tilting angle	100°
• Filter lighting®	2 Filters

Size

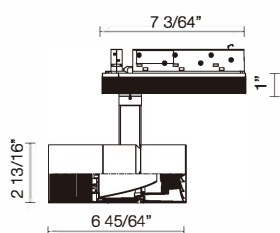

Track system designation

NORDIC : type TEK-44,48,412
NORDIC ALUMINIUM INC

• This fixture is compatible with 2-circuit track only.
The fixture attaches to both the left and right circuit rails of the track.
Please ensure that only one power feed is supplied to the track.

Additional Accesaries

• Lens Filter

Full-Diffuser lens filter

MLA-100/DF01



[data download](#)

Semi-Diffuser lens filter

MLA-100/DS02



[data download](#)

Full-spread lens filter

MLA-100/SF01



[data download](#)

Semi-Spread lens filter

MLA-100/SS01



[data download](#)

Edge-control lens filter

MLA-100/EC02



[data download](#)

Sharpeners lens filter

MLA-100/SH01



[data download](#)

Installation

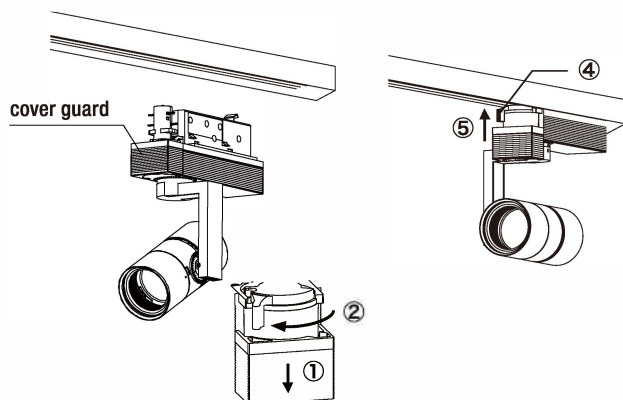

① Pull down the cover guard.
② Rotate the gear lever.

③ Push the driver box against the lighting rail.
④ Rotate the gear lever and lock it.
⑤ Push up the cover guard.

How to do tilt lock / pan lock

Each angle can be locked by allen wrench attached.

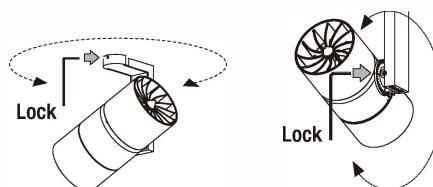

Light distribution

Narrow : 11°

N	11°				
H(ft)	E(ft-cd)	D(ft)	E(ft-cd)	2700K	3000K
3.28	2504	0.69	3.28ft	2368	2504
6.56	626	1.38	6.56ft	592	626
9.84	278	2.07	9.84ft	263	278
13.12	156	2.76	13.12ft	148	156

3000K / 2981Lm

Medium : 19°

M	19°				
H(ft)	E(ft-cd)	D(ft)	E(ft-cd)	2700K	3000K
3.28	1576	1.15	3.28ft	1491	1576
6.56	394	2.30	6.56ft	373	394
9.84	175	3.44	9.84ft	166	175
13.12	98	4.59	13.12ft	93	98

3000K / 2981Lm

Light distribution

Full-Diffuser lens filter | MLA-100/DF01

N	44°				
H(ft)	E(ft-cd)	D(ft)	E(ft-cd)	2700K	3000K
3.28	136	2.69	3.28ft	1928	136
6.56	34	5.38	6.56ft	48	34
9.84	15	8.07	9.84ft	20	15
13.12	8	10.76	13.12ft	11	8

for Narrow

for Narrow 3000K / 2981Lm

for Medium 3000K / 2981Lm

Semi-Diffuser lens filter | MLA-100/DS02

N	32°				
H(ft)	E(ft-cd)	D(ft)	E(ft-cd)	2700K	3000K
3.28	341	1.94	3.28ft	366	341
6.56	85	3.87	6.56ft	91	85
9.84	38	5.81	9.84ft	40	38
13.12	21	7.74	13.12ft	24	21

for Narrow

for Narrow 3000K / 2981Lm

for Medium 3000K / 2981Lm

Full-spread lens filter | MLA-100/SF01

N	13°/43°				
H(ft)	E(ft-cd)	D(ft)	E(ft-cd)	2700K	3000K
3.28	537	0.79/2.82	3.28ft	2799	537
6.56	134	1.57/5.25	6.56ft	69	134
9.84	60	2.36/7.87	9.84ft	32	60
13.12	34	3.15/10.50	13.12ft	18	34

for Narrow

for Narrow 3000K / 2981Lm

for Medium 3000K / 2981Lm

Semi-Spread lens filter | MLA-100/SS01

N	13°/33°				
H(ft)	E(ft-cd)	D(ft)	E(ft-cd)	2700K	3000K
3.28	873	0.75/1.97	3.28ft	939	873
6.56	218	1.51/3.94	6.56ft	23	218
9.84	97	2.26/5.91	9.84ft	10	97
13.12	55	3.02/7.87	13.12ft	6	55

for Narrow

for Narrow 3000K / 2981Lm

for Medium 3000K / 2981Lm

Edge-control lens filter | MLA-100/EC02

N	32°				
H(ft)	E(ft-cd)	D(ft)	E(ft-cd)	2700K	3000K
3.28	234	1.94	3.28ft	2515	234
6.56	58	3.87	6.56ft	62	58
9.84	26	5.81	9.84ft	26	26
13.12	15	7.74	13.12ft	15	15

for Narrow

for Narrow 3000K / 2981Lm

for Medium 3000K / 2981Lm

Sharpeners lens filter | MLA-100/SH01

N	9°				
H(ft)	E(ft-cd)	D(ft)	E(ft-cd)	2700K	3000K
3.28	2043	0.52	3.28ft	2198	2043
6.56	511	1.05	6.56ft	527	511
9.84	227	1.57	9.84ft	227	227
13.12	128	2.10	13.12ft	128	128

for Narrow

for Narrow 3000K / 2981Lm

Narrow only

The attachment of the filters



- Remove the lock by sliding the body along the arrow direction, and detach the hood from the body.



- Rotate the option holder in the hood along the arrow direction and take the option holder out from the hood.



- Put the filter into the hood.
 - ※ up to 2 filters can be inserted.
 - ※ The sharpeners are counted as 2 lens.



- Put back the option holder to the hood.



- Match the mark of the hood and the body and rotate the hood to lock.

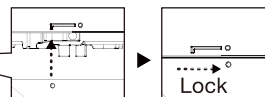

Contact

Mosheo Corporation
 2B Airport Drive Ext. Hopedale, MA 01747
 Phone : +1-774-804-3283
 E-mail : ModuleXSales@Mosheocorp.com

ModuleX