

ACCENT | Track light

data
download

MMP-060S/SH



Product code

[ex : Slant hood / White / NORDIC type / Narrow 11° / 3000K]

MMP-060S/SH/W/1N/N/10A 30/N1/ 2

Basic Product Series	Hood	Color	Track type	Light distribution	Light source	Color temperature	Driver type	Auth-entification
----------------------	------	-------	------------	--------------------	--------------	-------------------	-------------	-------------------

○NORDIC type

Dimming | Non-dimming

White MMP-060S/SH/W/1N/N.M/10A24.27.30.35.40/N1/2

Matte black MMP-060S/SH/M/1N/N.M/10A24.27.30.35.40/N1/2

Silver MMP-060S/SH/S/1N/N.M/10A24.27.30.35.40/N1/2

Products Specifications

- Input Voltage AC120V
- Power consumption 15.4W(AC120V)
- Luminance flux 941 ~ 1,088 lm
- Color rendering CRI (Ra)=93(typ)
- Fixture's weight 0.84 lbs
- Light distribution Narrow (11°) Medium (19°)
- Input current 0.129A (120V)
- Aiming distance 0.1m (3 15/16 in)
- Tilting angle 100°
- Filter lighting® 2 Filters

Size

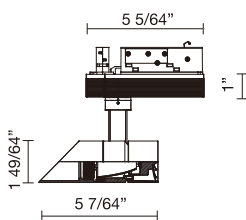

Track system designation

NORDIC : type TEK-44,48,412
NORDIC ALUMINIUM INC

- This fixture is compatible with 2-circuit track only. The fixture attaches to both the left and right circuit rails of the track. Please ensure that only one power feed is supplied to the track.

Additional Accesaries

• Lens Filter

Full-Diffuser lens filter

MLA-060/DF01



data
download

Semi-Diffuser lens filter

MLA-060/DS01



data
download

Full-spread lens filter

MLA-060/SF01



data
download

Semi-Spread lens filter

MLA-060/SS01



data
download

Edge-control lens filter

MLA-060/EC01



data
download

Sharpeners lens filter

MLA-060/SH01



data
download

Installation

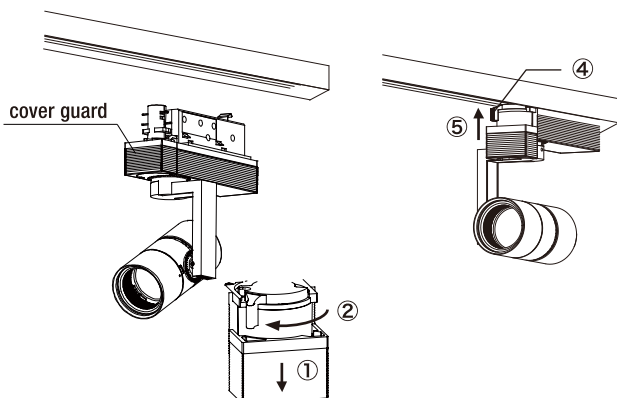

- ① Pull down the cover guard.
- ② Rotate the gear lever.

- ③ Push the driver box against the lighting rail.
- ④ Rotate the gear lever and lock it.
- ⑤ Push up the cover guard.

How to do tilt lock / pan lock

Each angle can be locked by allen wrench attached.

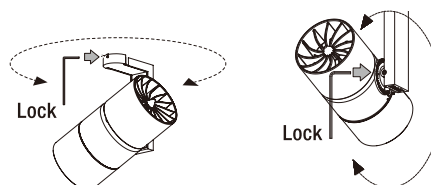

Light distribution

Narrow : 11°

N	11°				
H(ft)	E(ft-cd)	D(ft)	E(ft-cd)	2400K 941lm	2700K 992lm
3.28	820	0.69	3.28ft	741	781
6.56	205	1.38	6.56ft	185	195
9.84	91	2.07	9.84ft	82	87
13.12	51	2.76	13.12ft	46	49

3000K / 1042Lm

Medium : 19°

M	19°				
H(ft)	E(ft-cd)	D(ft)	E(ft-cd)	2400K 941lm	2700K 992lm
3.28	489	1.15	3.28ft	442	466
6.56	122	2.30	6.56ft	110	116
9.84	54	3.44	9.84ft	49	52
13.12	31	4.59	13.12ft	28	29

3000K / 1042Lm

Light distribution with Filter lighting®

Full-Diffuser lens filter | MLA-060/DF01

N	41°				
H(ft)	E(ft-cd)	D(ft)	E(ft-cd)	2400K 941lm	2700K 992lm
3.28	61	2.49	3.28ft	67	2.49
6.56	15	4.99	6.56ft	17	4.99
9.84	7	7.48	9.84ft	7	7.48
13.12	4	9.97	13.12ft	4	9.97

for Narrow

for Narrow 3000K / 1042Lm

for Medium 3000K / 1042Lm

Semi-Diffuser lens filter | MLA-060/DS01

N	33°				
H(ft)	E(ft-cd)	D(ft)	E(ft-cd)	2400K 941lm	2700K 992lm
3.28	127	1.97	3.28ft	127	1.97
6.56	32	3.94	6.56ft	32	3.94
9.84	14	5.91	9.84ft	14	5.91
13.12	8	7.87	13.12ft	8	7.87

for Narrow

for Narrow 3000K / 1042Lm

for Medium 3000K / 1042Lm

Full-spread lens filter | MLA-060/SF01

N	14°/41°				
H(ft)	E(ft-cd)	D(ft)	E(ft-cd)	2400K 941lm	2700K 992lm
3.28	177	0.85/2.49	3.28ft	147	1.15/2.66
6.56	44	1.71/4.99	6.56ft	37	2.30/5.31
9.84	20	2.56/7.48	9.84ft	16	3.44/7.97
13.12	11	3.41/9.97	13.12ft	9	4.59/10.63

for Narrow

for Narrow 3000K / 1042Lm

for Medium 3000K / 1042Lm

Semi-Spread lens filter | MLA-060/SS01

N	15°/31°				
H(ft)	E(ft-cd)	D(ft)	E(ft-cd)	2400K 941lm	2700K 992lm
3.28	303	0.89/1.87	3.28ft	303	0.89/1.87
6.56	76	1.77/3.74	6.56ft	76	1.77/3.74
9.84	34	2.66/5.61	9.84ft	34	2.66/5.61
13.12	19	3.54/7.48	13.12ft	19	3.54/7.48

for Narrow

for Narrow 3000K / 1042Lm

for Medium 3000K / 1042Lm

Edge-control lens filter | MLA-060/EC01

M	33°				
H(ft)	E(ft-cd)	D(ft)	E(ft-cd)	2400K 941lm	2700K 992lm
3.28	85	1.97	3.28ft	85	1.97
6.56	21	3.94	6.56ft	21	3.94
9.84	9	5.91	9.84ft	9	5.91
13.12	5	7.87	13.12ft	5	7.87

for Narrow

for Narrow 3000K / 1042Lm

for Medium 3000K / 1042Lm

Sharpen lens | MLA-060/SH01

N	9°				
H(ft)	E(ft-cd)	D(ft)	E(ft-cd)	2400K 941lm	2700K 992lm
3.28	637	0.56	3.28ft	637	0.56
6.56	159	1.12	6.56ft	159	1.12
9.84	71	1.67	9.84ft	71	1.67
13.12	40	2.23	13.12ft	40	2.23

for Narrow

for Narrow 3000K / 1042Lm

Narrow only

The attachment of the filters



- 1 Remove the lock by sliding the body along the arrow direction, and detach the hood from the body.



- 2 Rotate the option holder in the hood along the arrow direction and take the option holder out from the hood.



- 3 Put the filter into the hood.
※ up to 2 filters can be inserted.
※ The sharper lens are counted as 2 lens.



- 4 Put back the option holder to the hood.



- 5 Match the mark of the hood and the body and rotate the hood to lock.

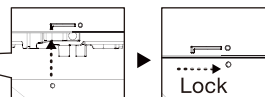

Contact

Mosheo Corporation
2B Airport Drive Ext. Hopedale, MA 01747
Phone : +1-774-804-3283
E-mail : ModuleXSales@Mosheocorp.com

ModuleX