

ACCENT | Track light

data
download

MMP-060S/5H



Product code

[ex : 50°Hood / White / EUTRAC type / Narrow 11° / 3000K]

MMP-060S/5H/W/1E/N/10A 30/Z1/ 2

Basic Product Series	Hood	Color	Track type	Light distribution	Light source	Color temperature	Driver type	Auth-entification
----------------------	------	-------	------------	--------------------	--------------	-------------------	-------------	-------------------

○EUTRAC type

Dimming | 0-10V | 3-100%

White	MMP-060S/5H/W/1E/N.M/10A24.27.30.35.40/Z1/2
Matte black	MMP-060S/5H/M/1E/N.M/10A24.27.30.35.40/Z1/2
Chrome	MMP-060S/5H/S/1E/N.M/10A24.27.30.35.40/Z1/2

○NORDIC type

Dimming | Non-dimming

White	MMP-060S/5H/W/1N/N.M/10A24.27.30.35.40/N1/2
Matte black	MMP-060S/5H/M/1N/N.M/10A24.27.30.35.40/N1/2
Chrome	MMP-060S/5H/S/1N/N.M/10A24.27.30.35.40/N1/2

Products Specifications

- Input Voltage AC120V
- Power consumption 15.4W(AC120V)
- Luminance flux 941 ~ 1,088 lm
- Color rendering CRI (Ra)=93(typ)
- Fixture's weight 0.87 lbs
- Light distribution Narrow (11°) Medium (18°)
- Input current 0.129A (120V)
- Aiming distance 0.1m (3 15/16 in)
- Tilting angle 100°
- Filter lighting® 2 Filters

Size

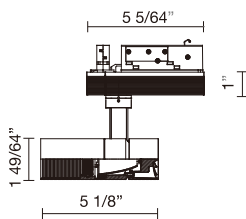

Track system designation

EUTRAC : Series 230,233
EUTRAC CORP NA

NORDIC : type TEK-44,48,412
NORDIC ALUMINIUM INC

- This fixture is compatible with 2-circuit track only. The fixture attaches to both the left and right circuit rails of the track. Please ensure that only one power feed is supplied to the track.

Installation

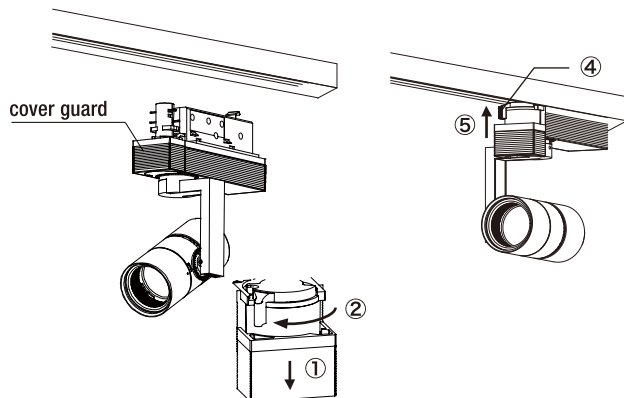

- ① Pull down the cover guard.
- ② Rotate the gear lever.
- ③ Push the driver box against the lighting rail.
- ④ Rotate the gear lever and lock it.
- ⑤ Push up the cover guard.

Additional Accesaries

• Lens Filter

Full-Diffuser lens filter
MLA-060/DF01



data
download

Semi-Diffuser lens filter
MLA-060/DS01



data
download

Full-spread lens filter
MLA-060/SF01



data
download

Semi-Spread lens filter
MLA-060/SS01



data
download

Edge-control lens filter
MLA-060/EC01



data
download

Sharpener lens filter
MLA-060/SH01



data
download

How to do tilt lock / pan lock

Each angle can be locked by allen wrench attached.

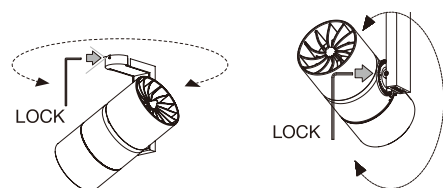

Light distribution

Narrow : 11°

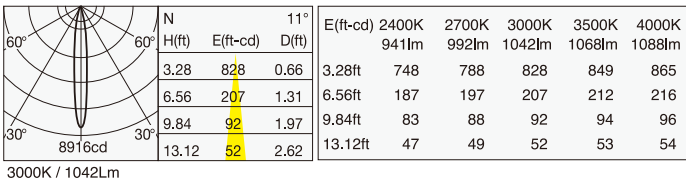

Medium : 18°

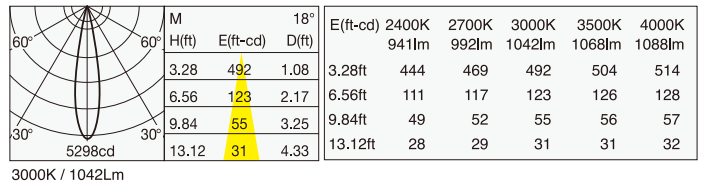

Light distribution with Filter lighting®

Full-Diffuser lens filter | MLA-060/DF01

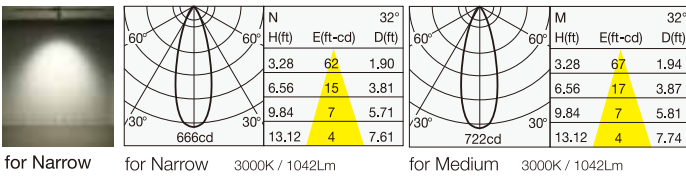

Semi-Diffuser lens filter | MLA-060/DS01

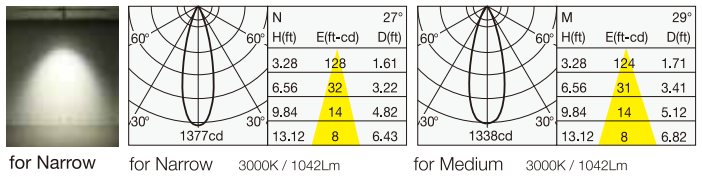

Full-spread lens filter | MLA-060/SF01

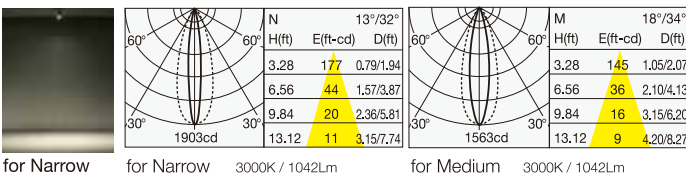

Semi-Spread lens filter | MLA-060/SS01

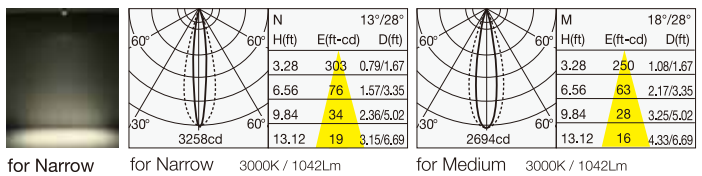

Edge-control lens filter | MLA-060/EC01

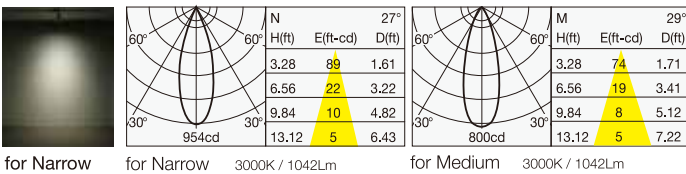

Sharpener lens | MLA-060/SH01

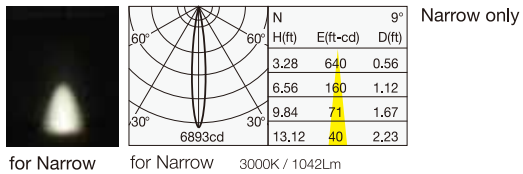

The attachment of the filters



① Remove the lock by sliding the body along the arrow direction, and detach the hood from the body.



② Rotate the option holder in the hood along the arrow direction and take the option holder out from the hood.



③ Put the filter into the hood.
 ※ up to 2 filters can be inserted.
 ※ The sharpener lens are counted as 2 lens.



④ Put back the option holder to the hood.

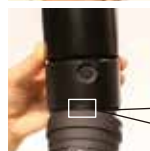

⑤ Match the mark of the hood and the body and rotate the hood to lock.

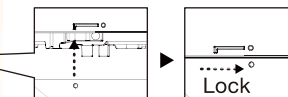

Contact

Mosheo Corporation
 2B Airport Drive Ext. Hopedale, MA 01747
 Phone : +1-774-804-3283
 E-mail : ModuleXSales@MosheoCorp.com