

ACCENT | Accent downlight

data
download

MMP-060A



Product code

[ex : Chrome cone / White trim / Narrow 11° / 3000K]

MMP-060A/CC/SWF/N/10A 30/T1/ 2

Basic Product Series	Cone color	Trim color	Light distribution	Light source	Color temperature	Driver type	Auth-entification
----------------------	------------	------------	--------------------	--------------	-------------------	-------------	-------------------

◎Dimming | Phase control | 10-100%

White	MMP-060A/WC/SWF/N.M/ 10A24.27.30.35.40/T1/2
Matte black	MMP-060A/MC/SWF.SMF/N.M/ 10A24.27.30.35.40/T1/2
Chrome	MMP-060A/CC/SWF.SMF/N.M/ 10A24.27.30.35.40/T1/2

Products Specifications

· Input Voltage	AC120 ~ 277V
· Power consumption	13.5W(AC120V) / 14.9W(AC277V)
· Luminance flux	941 ~ 1,088 lm
· Color rendering	CRI (Ra)=93(typ)
· Fixture's weight	1.19 lbs
· Light distribution	Narrow (11°) Medium (20°)
· Input current	0.35A
· Aiming distance	0.2m (7 7/8in)
· Ceiling thickness	23/64 ~ 63/64 in
· Tilting angle	35°
· Filter lighting®	2 Filters

Size

Size of hole for installation
2 7/16"

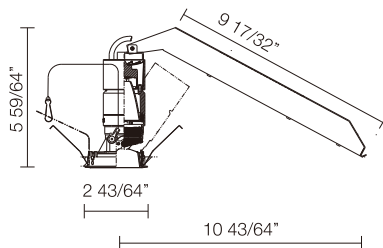

Installation

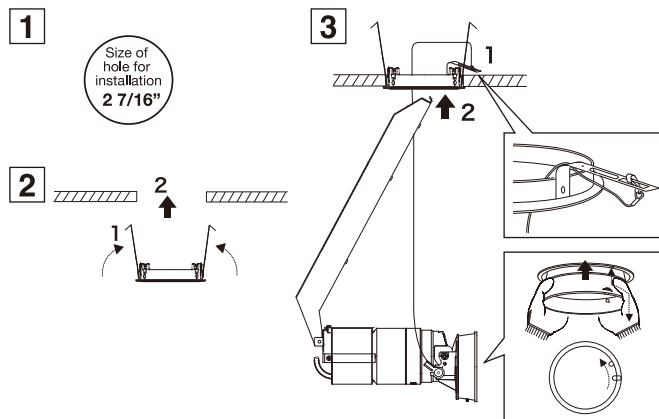

Additional Accesaries

· Lens Filter

Full-Diffuser lens filter
MLA-060/DF01



data
download

Semi-Diffuser lens filter
MLA-060/DS01



data
download

Full-spread lens filter
MLA-060/SF01



data
download

Semi-Spread lens filter
MLA-060/SS01



data
download

Edge-control lens filter
MLA-060/EC01



data
download

Sharpeners lens filter
MLA-060/SH01



data
download

How to do tilt lock



Adjust the angle by looking at the scale and tighten the screw with the hexagon wrench to fix the angle.

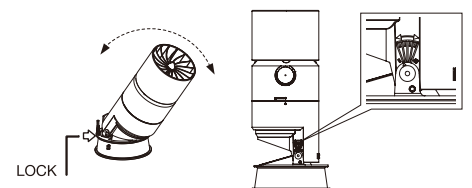

Light distribution (for Chrome cone)

Narrow : 11°

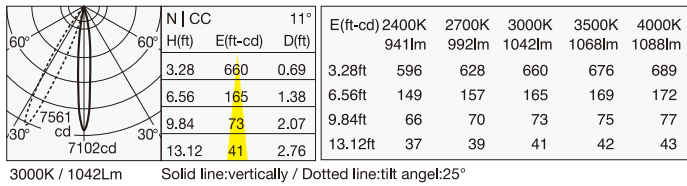

Medium : 20°

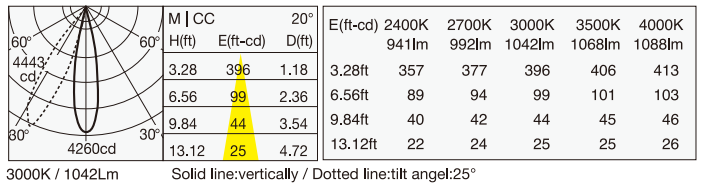

Light distribution (for Chrome cone) with Filter lighting[®]

Full-Diffuser lens filter | MLA-060/DF01

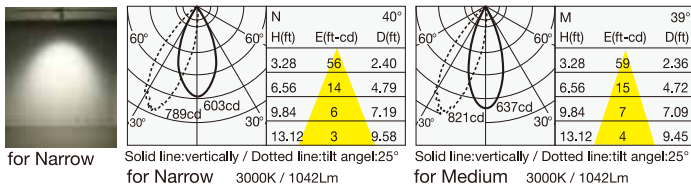

Semi-Diffuser lens filter | MLA-060/DS01

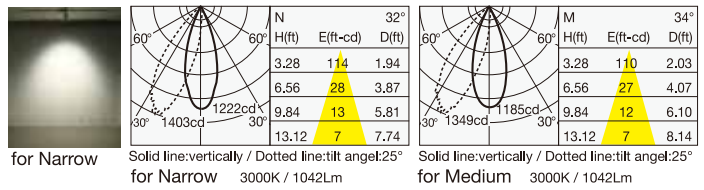

Full-spread lens filter | MLA-060/SF01

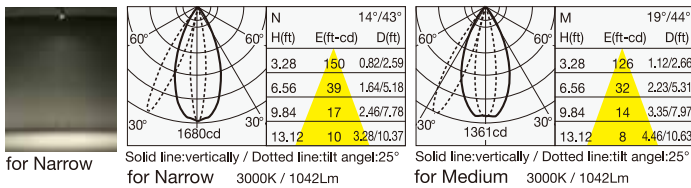

Semi-Spread lens filter | MLA-060/SS01

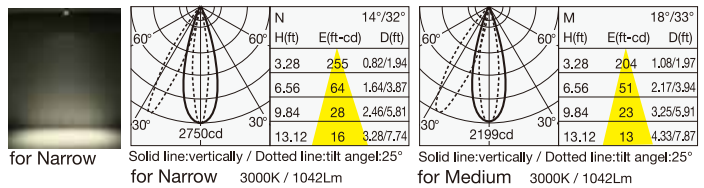

Edge-control lens filter | MLA-060/EC01

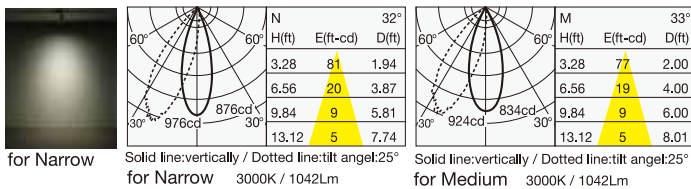

Sharpener lens | MLA-060/SH01

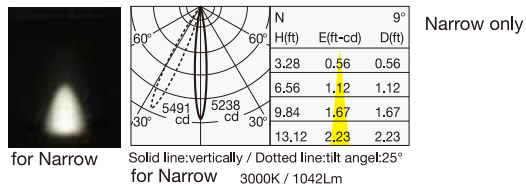

The attachment of the filters



- Remove the lock by sliding the body along the arrow direction, and detach the hood from the body.
- Rotate the option holder in the hood along the arrow direction and take the option holder out from the hood.
- Put the filter into the hood.
※ up to 2 filters can be inserted.



- Put back the option holder to the hood.
- Match the mark of the hood and the body and rotate the hood to lock.

<p>Contact</p>	<p>Mosheo Corporation 2B Airport Drive Ext. Hopedale, MA 01747 Phone : +1-774-804-3283 E-mail : ModuleXSales@Mosheocorp.com</p>	
-----------------------	---	--