

SPECIFICATION

- Light Source LED Module (Mounted)
- Input Voltage AC120V(Dedicated driver input voltage)
- Input current 0.454A(AC120V input)
- Power Consumption 53.9W(AC120V input)
- Dedicated Driver Constant current (50/60Hz shared)
- Weight 2.40 lbs,1090g (Driver weight is included)
- Dimming Control 0-10V
- Dimming Range 3%-100%
- UL File number E477257
- delivered lumen
(N)for Narrow 43.9Lm/W(AC120V input)
(M)for Medium 51.1Lm/W(AC120V input)
- life rating 50,000hours. L70
- warranty coverage 5 years
- CRI(Ra) 93 typ
- color temperature 2700K,3000K,3500K,4000K

Narrow

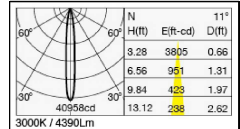

Medium

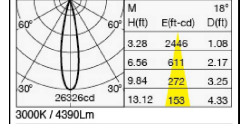

E(ft-cd)	2700K	3000K	3500K	4000K
4161lm	4390lm	4488lm	4577m	
3.28ft	3607	3805	3890	3967
6.56ft	902	951	973	992
9.84ft	401	423	432	441
13.12ft	225	238	243	248

PRODUCT CODE

- MMP-130S/3H/W or M or S/1E/N/40B27/Z2/2
- MMP-130S/3H/W or M or S/1E/N/40B30/Z2/2
- MMP-130S/3H/W or M or S/1E/N/40B35/Z2/2
- MMP-130S/3H/W or M or S/1E/N/40B40/Z2/2
- MMP-130S/3H/W or M or S/1E/M/40B27/Z2/2
- MMP-130S/3H/W or M or S/1E/M/40B30/Z2/2
- MMP-130S/3H/W or M or S/1E/M/40B35/Z2/2
- MMP-130S/3H/W or M or S/1E/M/40B40/Z2/2

HOW TO READ THE PRODUCT CODE

MMP-130S/3H/W/1E/N/40B27/Z2/2
1 2 3 4 5 6 7 8 9

- 1 Basic product Series
- 2 Hood type (3H)for 30° hood
- 3 Choose the letter code to designate the desired color of Product (W)for White (M)for Matte Black (S)for Silver
- 4 Adapter Type (1E)for Eutrac Corp NA
- 5 Choose the letter code to designate the desired light distribution (N)for Narrow 11° (M)for Medium 18°
- 6 Light Source
- 7 Choose the letter code to designate the desired Color Temperature (27)for 2700K (30)for 3000K (35)for 3500K (40)for 4000K
- 8 Designates led driver type (Z2)for Original Driver 0-10V Dimming Control
- 9 Authentication (2)for UL/cUL

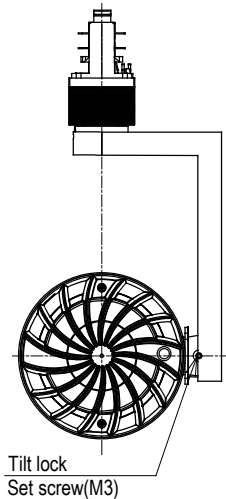
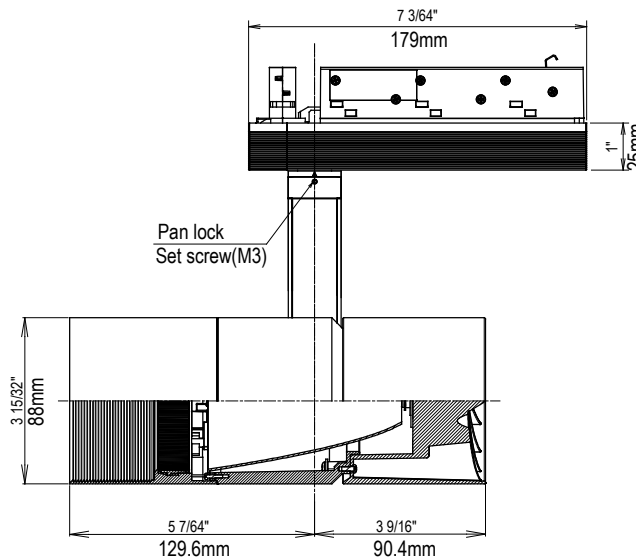
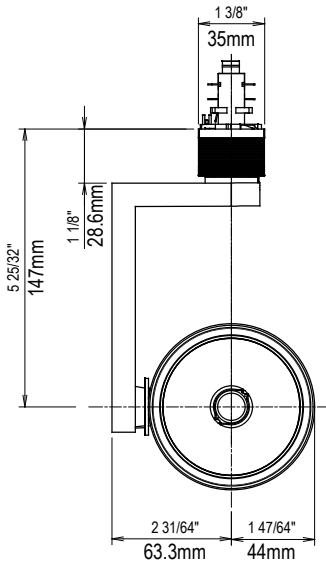

ATTENTION

- This fixture is compatible with Eutrac 2-circuit track only. The fixture attaches to both the left and right circuit rails of the track. Please ensure that only one power feed is supplied to the track.
- Use 0-10V control dimming system (DVSTV-XX(Sold separately))only.

Lens Filter options

- Full-Diffuser Lens Filter MLA-130/DF01
- Semi-Diffuser Lens Filter MLA-130/DS02
- Full-Spread Lens Filter MLA-130/SF01
- Semi-Spread Lens Filter MLA-130/SS01
- Edge Control Lens Filter MLA-130/EC02
- Sharpener Lens MLA-130/SH01 (available only for narrow distribution)

